



COLORADO RIFLE CLUB



May 18, 2015

See Page 2 for a map of the area.

[Click here for more details on how to get to the range via Rector/Leader Road.](#)

## BIJOU BRIDGE WASHED OUT ACCESS TO RANGE VIA 96TH BLOCKED

There has been a wash-out of 96th Avenue at the Bijou bridge approach a mile west of the Colorado Rifle Club ranges entrance. The bridge is intact, but there is no way around the road wash out. This affects anyone who tries to come on 96th Avenue from west. The only entrance is now on 96th Avenue from the east on Rector/Leader, County Rd 52. Those coming from the north will have to find a way from the Prospect Valley Road to Hoyt and south on Minosa Rd to 96th, or drive south to Byers and US 36 and pick up Rector Leader to the range again.

We have no idea when the road will be repaired and open again, but we suspect that it will be a low priority for the county.



# UPCOMING EVENTS

## May 23

[Smallbore Prone League](#)  
[Any Sights - Smallbore Range](#)

IDPA Pistol - East Range  
Berms 1-7

Marine Corp League -  
Schuetzen Range

## May 24

Cowboy Action - East  
Range Berms 1-7, 200

IMHSA Bigbore Silhouette  
- Silhouette Range

[Black Powder Long Range -  
High Power Range](#)

## May 25

Lever Rifle Silhouette -  
Silhouette Range

## May 30

Firearms Safety For New &  
Non Competitive Members  
- Smallbore Stat Building &  
Schuetzen Range

Rimfire Challenge - East  
Range Berms 1-7

## May 30-31

Boy Scouts - Sporting Clays  
and Smallbore Range

## May 31

80 Shot High Power - High  
Power Range

## June 5-6

USPSA Multigun (MEGA)-  
East Range Berms 7-13

## June 6

Sporting Clays

IMHSA Smallbore -  
Silhouette Range

## June 6-7

[Rocky Mountain Regional  
Smallbore Prone -  
Smallbore Range](#)

[Eastern Colorado NRA  
Pistol Regional - Pistol  
Range](#)

## June 7

NBRSA Championship  
Sight-in - High Power  
Range

Cowboy Action Shooting  
Clinic - East Berms 1-6

High Power Rifle Silhouette  
- Silhouette Range

**Always check the  
Event Schedule for  
activities before  
going to the range!**

## Colorado, United States, North America

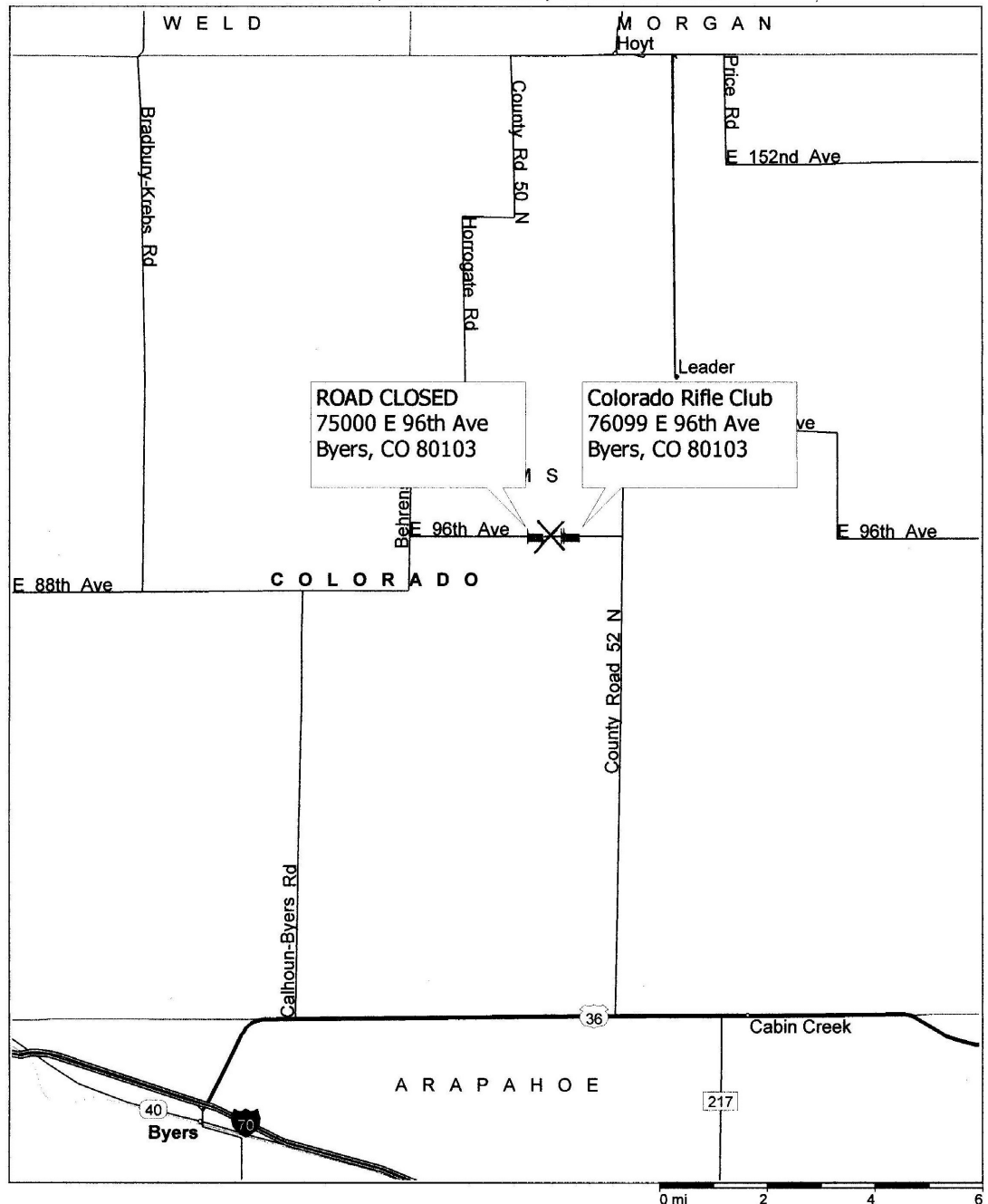

Copyright © and (P) 1988-2012 Microsoft Corporation and/or its suppliers. All rights reserved. <http://www.microsoft.com/streets/>  
Certain mapping and direction data © 2012 NAVTEQ. All rights reserved. The Data for areas of Canada includes information taken with permission from Canadian authorities, including: © Her Majesty the Queen in Right of Canada, © Queen's Printer for Ontario. NAVTEQ and NAVTEQ ON BOARD are trademarks of NAVTEQ. © 2012 Tele Atlas North America, Inc. All rights reserved. Tele Atlas and Tele Atlas North America are trademarks of Tele Atlas, Inc. © 2012 by Applied Geographic Solutions. All rights reserved. Portions © Copyright 2012 by Woodall Publications Corp. All rights reserved.

Get all the news and photos at  
<http://crici.org/>